

PLAT OF SURVEY

A PARCEL OF LAND LOCATED IN THE SOUTHEAST 1/4 OF THE NORTHEAST 1/4 OF SECTION 25 IN TOWNSHIP 2 NORTH, RANGE 17 EAST, IN THE CITY OF LAKE GENEVA, WALWORTH COUNTY, WISCONSIN.

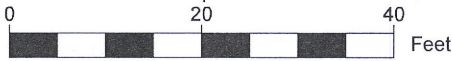
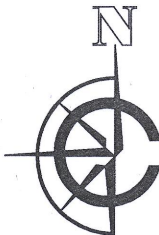

SCALE: 1"=20'

- NOTE:
- 1. BASIS OF BEARING: THE WISCONSIN STATE PLANE COORDINATE SYSTEM, NAD-83, SOUTH ZONE.
 - 2. FIELD WORK COMPLETED AUGUST 18, 2020
 - 3. BUILDING SURVEYED TO THE EXTERIOR OF SIDING.
 - 4. FIELD CREW CHIEF: LOGAN RANDLE

LEGAL DESCRIPTION:

A PARCEL OF LAND LOCATED IN THE SOUTHEAST 1/4 OF THE NORTHEAST 1/4 OF SECTION 25 IN TOWNSHIP 2 NORTH, RANGE 17 EAST, IN THE CITY OF LAKE GENEVA, WALWORTH COUNTY, WISCONSIN, MORE PARTICULARLY DESCRIBED AS:

LOT 8 OF KOHN'S SECOND SUBDIVISION IN THE CITY OF LAKE GENEVA, PER DOCUMENT NUMBER P157812 IN THE WALWORTH COUNTY REGISTER OF DEEDS.

SURVEY ORDERED BY:

MARK LARKIN

PROPERTY ADDRESS:

724 RODGERS COURT,
LAKE GENEVA, WI 53147

SURVEYOR:

PAUL H. VAN HENKELUM, PLS
CARDINAL ENGINEERING LLC

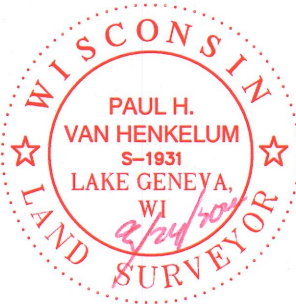

"I HEREBY CERTIFY THAT I HAVE SURVEYED THE ABOVE DESCRIBED PROPERTY AND THE MAP IS A TRUE AND CORRECT REPRESENTATION OF ITS EXTERIOR BOUNDARIES AND SHOWS THE SIZE AND LOCATION OF ALL VISIBLE STRUCTURES, APPARENT EASEMENTS AND ENCROACHMENTS, IF ANY."

Paul H. Van Henkelum
PAUL H VAN HENKELUM, PLS #1931

8/26/2020
DATE

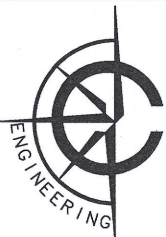

CARDINAL ENGINEERING LLC
DESIGNING IN TRUE DIRECTIONS

PO BOX 281 - 1200 LA SALLE ST.
LAKE GENEVA, WI 53147
262-757-8776
CARDINALENGINEERINGWI.COM

DATE: 08/26/2020 JOB No. 20430
SHEET 1 OF 1

RODGERS COURT 50' R/W

LOT 7
KOHNS 2ND SUBDIVISION

LOT 2
KOHNS 2ND SUBDIVISION

LOT 1
KOHNS 2ND SUBDIVISION

LOT 8

EXISTING SHED



N89° 49' 04"E 70.21'

LOT 4 OF GARDNER'S ADDITION

LOT 1 OF GARDNER'S ADDITION

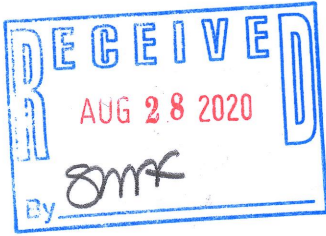

LEGEND

- FOUND 1" IRON PIPE
- (XX) RECORDED AS
- EXISTING CONCRETE
- EXISTING BUILDING
- EXISTING UTILITY POLE
- XWD— EXISTING FENCE

ZK2-6

007-3743